

OCEAN DRIVE

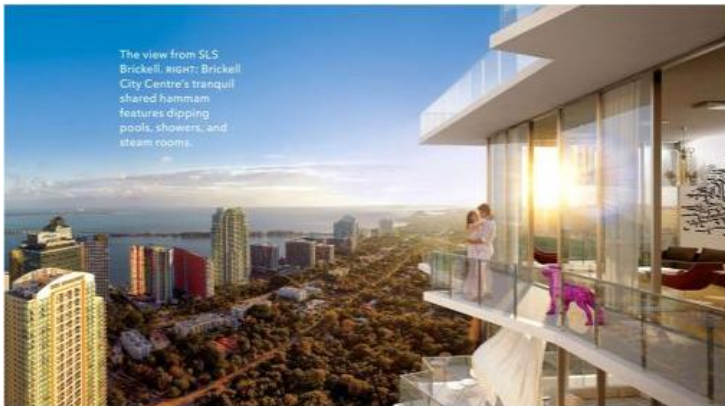

The view from SLS Brickell. RIGHT: Brickell City Centre's tranquil shared hammam features dipping pools, showers, and steam rooms.

"BRICKELL IS VERY QUICKLY DELIVERING ON ITS PROMISES."

—CARLOS ROSSO



The Altitude Pool Deck (LEFT) at SLS Brickell (SHOWN HERE) offers sun and skyline views for those staying in the hotel's luxurious and spacious suites (BOTTOM LEFT).



office buildings, has been a catalyst in the neighborhood, creating a buzz that is attracting residents and visitors alike.

"We've tried to create a very vibrant center that caters to all types," says Kieran Bowers, president of Swire Properties, Brickell City Centre's developer. The 352-key East, for instance, has a bit of an edge to it, Bowers says. Its rooftop bar, Sugar (East, Miami, 788 Brickell Plaza, 786-805-4655; east-miami.com), has already become a destination, and the hotel's signature restaurant, Quinto La Huella (788 Brickell Plaza, 786-805-4646; quintolahuella.com), is the first Miami location for Uruguay's much-vaunted beachfront eatery Parador La Huella. Brickell City Centre's pair of 43-story condominium towers, Reach and Rise, each have a half-acre amenity deck, with tropical gardens, barbecues, fitness areas, and a playground, as well as pools with beverage service, a library, fitness center, and spa with a shared hammam.

Other Brickell-area hotels, condominiums, and apartments offer extensive amenities as well. Related's 58-story SLS Lux (444 Brickell Ave., 305-358-1000; sslslux.com) features museum-quality art in all its common areas, as well as a ground-floor restaurant by celebrated chef

Katsuya Uechi and a cocktail lounge by SBar. Residents can also enjoy the SLS Lux Garden Level, with two pools and sporting and recreational amenities overlooking the Brickell skyline. Another Related condominium, Brickell Heights (850 S. Miami Ave., 305-469-9470; brickellheights.com), is home to both an Equinox fitness center and SoulCycle studio. And guests at the 124-room SLS Brickell (1300 S. Miami Ave., 305-239-1300; sslshotels.com) can be pampered at the luxurious Ciel Spa and then indulge in the cuisine at Bazaar Mar, by José Andrés, or Fi'lia, by Michael Schwartz—both James Beard Award-winning chefs.

Then there's the forthcoming Panorama Tower—an 85-story luxury rental by Florida East Coast Realty that will be the tallest building in Florida. It features 821 apartments and 208 hotel rooms, as well as 50,000 square feet of high-end retail and 100,000 square feet of medical office space. You'll find a pool deck with two heated pools and cabanas—but there's also a poolside bar/café, restaurant, private dining and wine-tasting rooms, a sports lounge, three private theaters, a fitness center, yoga and Pilates studio, spa, cyber café with coffee bar, play room, and Muse room for live music sessions. And, for the ultimate in convenience for pet owners, Panorama has a pet daycare, grooming, and boarding facility right in the building.

"Because of the size of this project, we're able to provide a plethora of amenities," says Jerome Hollo, the executive vice president of Florida East Coast Realty. "We've got everything that you could want"—proving Brickell is becoming unbeatable. ■



Kitchens at Brickell City Centre incorporate Italian cabinetry, sleek quartz-stone countertops, and imported marble flooring. ABOVE: The jewels of the Reach tower's amenity deck are the lap and social pools, featuring poolside beverage and café service.

OCEAN DRIVE

May 1, 2017

Circulation: 52,534/ UMV: 48,676

NONE OF US CAN MOVE FORWARD IF HALF OF US ARE HELD BACK

BECOME A GLOBAL CITIZEN AND
TAKE ACTION FOR GENDER EQUALITY

**GLOBAL
CITIZEN** + **CHIME
FOR CHANGE**
FOUNDED BY G. U. C. C. I.

JOINING FORCES FOR GENDER EQUALITY

GLOBALCITIZEN.ORG/LEVELTHELAW

Schwartz
MEDIA STRATEGIES
PR > Marketing

AMENITY CENTRAL

MORE THAN JUST AN URBAN SETTING, BRICKELL ENTERS ITS NEXT PHASE OFFERING LIFESTYLE, CULINARY, AND CULTURAL COMPONENTS.
BY ROBYN A. FRIEDMAN

Looking for a new place? Consider Brickell. No longer just a financial center, Brickell has morphed into a bustling live/work/play residential neighborhood, with a hip lifestyle and urban vibe—not to mention easy access to some of the city's best shopping and dining.

"A few years ago, when we were first starting to sell SLS Brickell, we used to show renderings of families with strollers walking around the city or enjoying Brickell at the curbside restaurants," says Carlos Rosso, president of The Related Group's Condominium Development Division. "Flash forward to today, and you'll see hundreds of people around the neighborhood 24 hours a day, seven days a week. The neighborhood is very quickly delivering on its promises and making those renderings come to life."

According to the Miami Downtown Development Authority, Brickell's population increased by 32.1 percent between 2010 and 2016—and it's expected to grow an additional 9.1 percent by 2021. Numerous shops and restaurants have followed, drawn by the residential influx. Brickell City Centre (701 S. Miami Ave., 786-254-1045; brickellcitycentre.com), an urban oasis that encompasses 500,000 square feet of retail and entertainment space; the luxury East, Miami hotel; the Reach and Rise condominium towers; and two

SPACE

REAL ESTATE & DESIGN

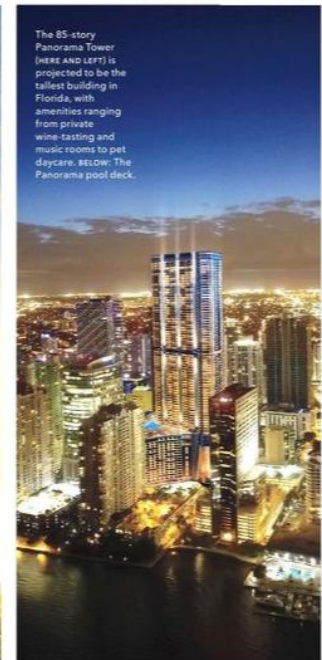

The 85-story Panorama Tower (HERE AND LEFT) is projected to be the tallest building in Florida, with amenities ranging from private wine-tasting and music rooms to pet daycare. BELOW: The Panorama's pool deck.

